

Front view and mounting

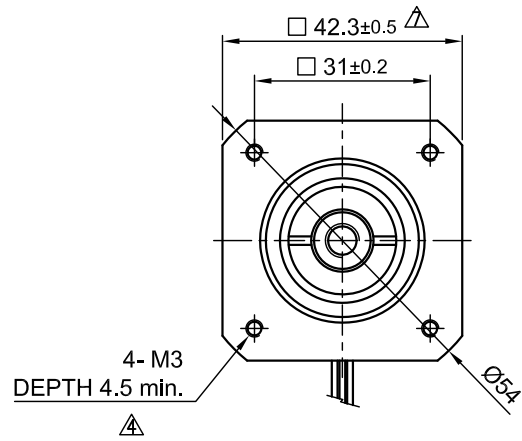

Side view

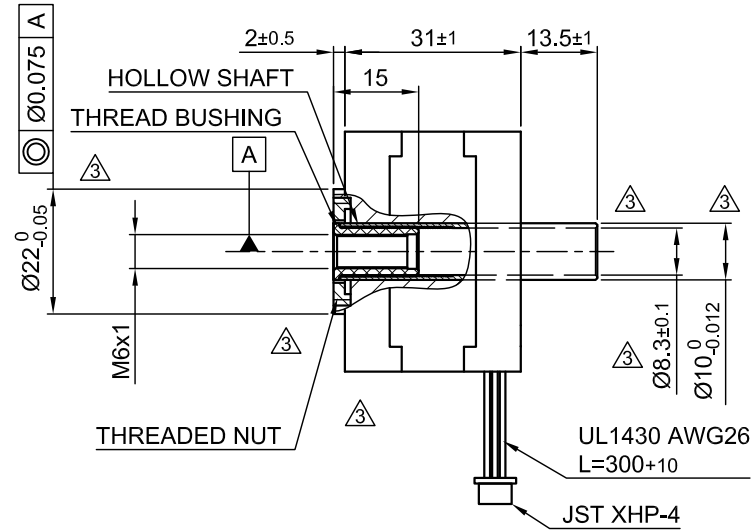

Rear view

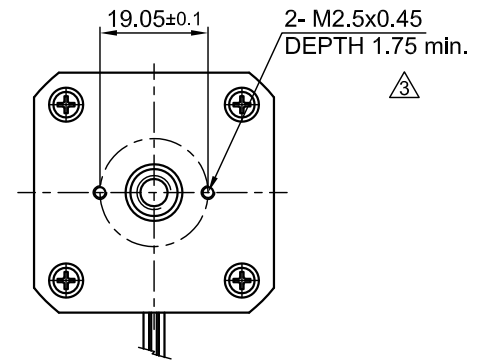

SPECIFICATION	
VOLTAGE (VDC)	2.8
AMPS/PHASE	1.4
RESISTANCE/PHASE (Ohms)@25°C	2.0±15%
INDUCTANCE/PHASE (mH) @1KHz	2.8±20% 1
SPINDLE PITCH (mm) [in]	1 [0.039]
THRUST (N)	300 6
RESOLUTION (mm/STEP)	0.005 2
STATIC TRUST (NO CURRENT)	>300 2
MAX. SPEED (mm/sec.)	20 2
MAX. SPEED WITH MAX. TRUST (mm/sec.)	8 2
WEIGHT (kg)	0.2
TEMPERATURE RISE: MAX.80°C (MOTOR STANDSTILL; FOR 2 PHASE ENERGIZED)	
AMBIENT TEMPERATURE -10°~ 50°C [14°F ~ 122°F]	
INSULATION RESISTANCE 100 MOhm (UNDER NORMAL TEMPERATURE AND HUMIDITY)	
INSULATION CLASS B 130° [266°F]	
DIELECTRIC STRENGTH 500VAC FOR 1 MIN. (BETWEEN THE MOTOR COILS AND THE MOTOR CASE)	
AMBIENT HUMIDITY MAX. 85% (NO CONDENSATION)	

Please regard the application note at www.nanotec.com for further informations. 5

Shaft play is adjustable at the motor.

PIN NO	TYPE OF CONNECTION (EXTERN)		MOTOR	
	BIPOLAR	LEADS	WINDING	
1	A —	BRN	A	
2	A\ —	ORG	A\	
3	B —	RED	B	
4	B\ —	YEL	B\	

WIRING DIAGRAM

FULL STEP 2 PHASE-Ex., WHEN FACING MOUNTING END (X)

STEP	A	B	A\	B\		CCW
1	+	+	-	-		↑
2	-	+	+	-		↓
3	-	-	+	+		
4	+	-	-	+		

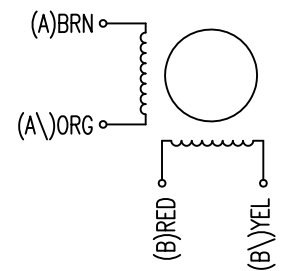

7	change tolerance	15.09.16	A.S.
6	change THRUST	14.06.16	A.S.
5	remove axial- and radial play	02.12.15	A.S.
REV	DESCRIPTION	DATE	DRN

Nanotec[®]
PLUG & DRIVE

Surface specification DIN ISO 1302	General tolerances DIN ISO 2768- cH	Work piece edge DIN ISO 13715
---------------------------------------	--	----------------------------------

APVD	S.H.	04.06.09
CHKD		
DRN	J.W.	04.06.09
SIGNATURE	DATE	

LINEAR AKTUATOR

DWG.NO
L4118S1404-M6x1