

Front view and mounting

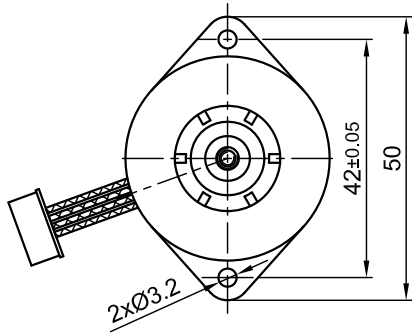

Side view

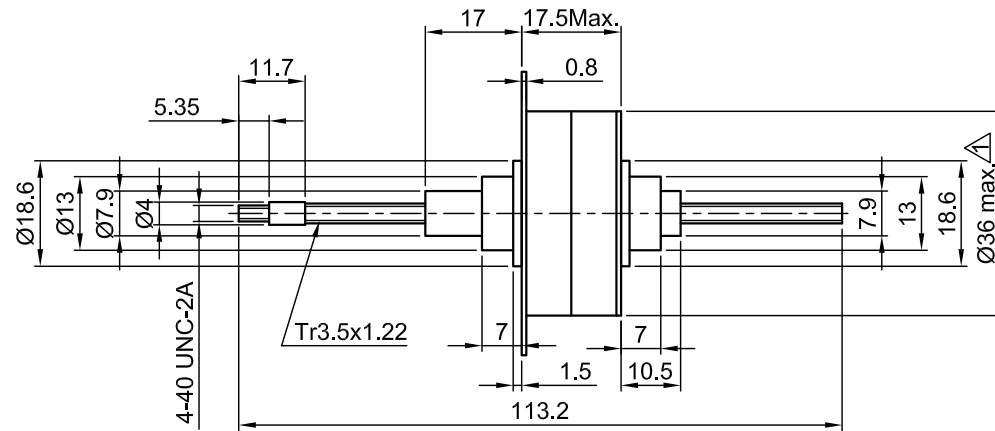

Rear view

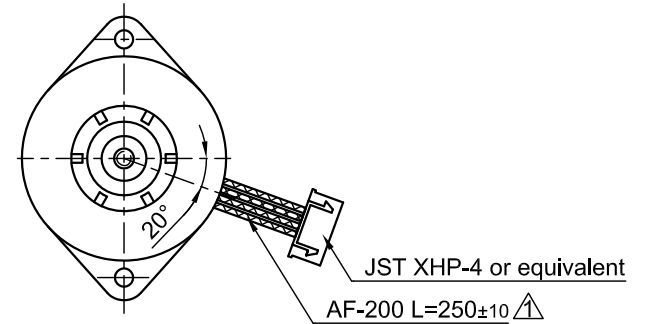

SPECIFICATION	CONNECTION	BIPOLAR
VOLTAGE (VDC)		5.0
AMPS/PHASE		0.46
RESISTANCE/PHASE (Ohms)@25°C		11±10%
INDUCTANCE/PHASE (mH) @1KHz		8.6±20%
PITCH (mm)		1.22
STEP ANGLE (°)		7.5
RESOLUTION (mm/STEP)		0.0254
THRUST (N) [lbf] @100Hz		55 [12.36]
STROKE (mm)		75
WEIGHT (Kg) [lb]		0.086 [0.189]
TEMPERATURE RISE: MAX.75°C (MOTOR STANDSTILL; FOR 2 PHASE ENERGIZED)		
AMBIENT TEMPERATURE -10~ 40°C [14°F ~ 104°F] ▲		
INSULATION RESISTANCE 100 MOhm (UNDER NORMAL TEMPERATURE AND HUMIDITY)		
INSULATION CLASS E 120° [248°F]		
DIELECTRIC STRENGTH 600VAC FOR 1 MIN. (BETWEEN THE MOTOR COILS AND THE MOTOR CASE)		
AMBIENT HUMIDITY MAX. 85% (NO CONDENSATION)		

TYPE OF CONNECTION (EXTERN)	MOTOR			
	BIPOLAR	CONNECTOR PIN NO.	LEADS	WINDING
A —	1	WHT	A	
A\ —	2	RED	A\	
B —	3	BLU	B	
B\ —	4	YEL	B\	

FULL STEP 2 PHASE-Ex.,  
WHEN FACING MOUNTING END (X)

STEP	A	B	A\	B\		CCW
1	+	+	-	-		↑
2	-	+	+	-		
3	-	-	+	+		
4	+	-	-	+		

WIRING DIAGRAM

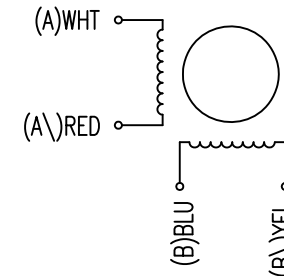

REV	DESCRIPTION	DATE	APVD	SCALE FREE	APVD	S.Ha.	04.07.08	LINEAR ACTUATOR
1	DIM.+TOLERANCE+AMBIENT TEM.	03.03.10	J.W.	X ±0.5	CHKD			DWG.NO
				1PL ±0.2	DRN	J.W.	14.01.08	
				2PL ±0.1	SIGNATURE			
				ANGLE ±30'				LP3575S0504-TR3.5X1.22



LP3575S0504-TR3.5x1.22