

Front view and mounting

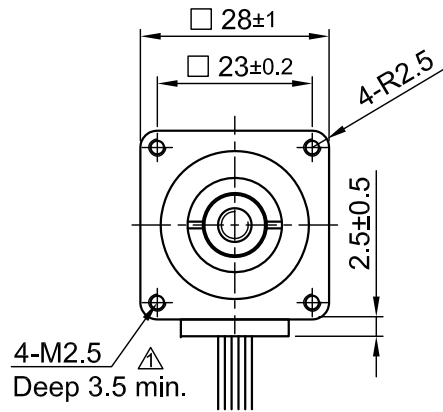

Side view

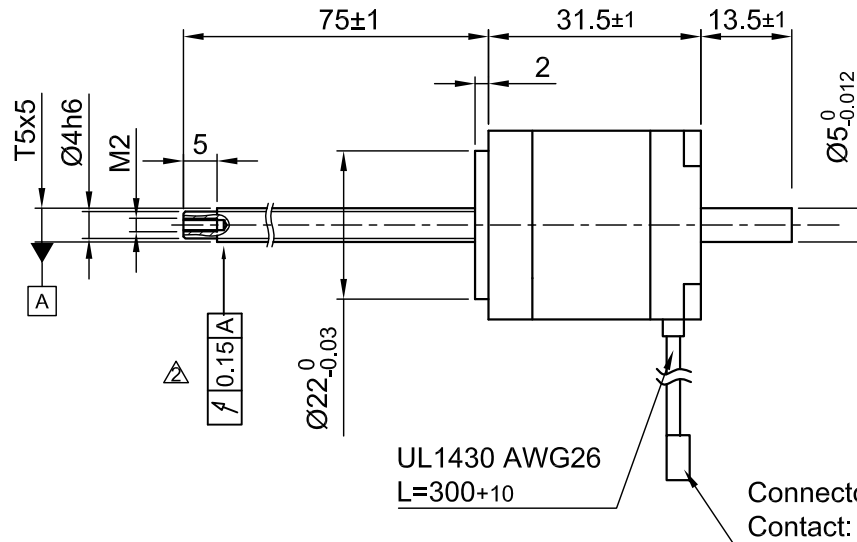

Rear view

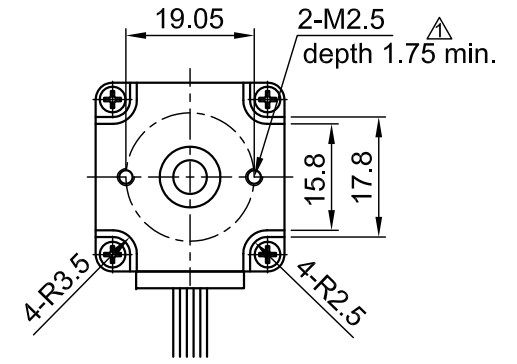

Please regard the application note at www.nanotec.com for further informations.

Shaft play is adjustable at the motor.

| TYPE OF CONNECTION (EXTERN) | MOTOR | | |
|-----------------------------|---------|-------|---------|
| | BIPOLAR | LEADS | WINDING |
| 1 | A — | BLK | A |
| 2 | A\ — | GRN | A\ |
| 3 | B — | RED | B |
| 4 | B\ — | BLU | B\ |

WIRING DIAGRAM

FULL STEP 2 PHASE-Ex., WHEN FACING MOUNTING END (X)

| STEP | A | B | A\ | B\ | CCW |
|------|---|---|----|----|-----|
| 1 | + | + | - | - | ↓ |
| 2 | - | + | + | - | |
| 3 | - | - | + | + | ↑ |
| 4 | + | - | - | + | |

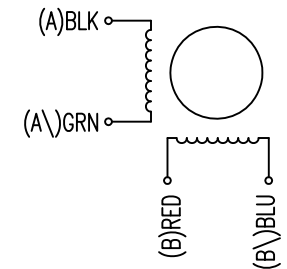

| SPECIFICATION | CONNECTION | BIPOLAR |
|------------------------------------------------------------------------------------|------------|--------------|
| AMPS/PHASE | | 0.67 |
| RESISTANCE/PHASE (Ohms)@25°C | | 5.6±15% |
| INDUCTANCE/PHASE (mH) @1KHz | | 4.0±20% |
| THUST (N) [lbf] | | 30 [6.75] |
| RESOLUTION (mm/STEP) | | 0.025 |
| STATIC THRUST (N) [lbf] (NO CURRENT) | | 13 [2.925] |
| MAX. SPEED (mm/sec.) AT 48V | | 100 |
| MAX. SPEED WITH MAX. THRUST (mm/sec.) AT 48V | | 50 |
| STEP ANGLE (°)+ACCURACY | | 1.8±5% |
| WEIGHT (Kg) [lb] | | 0.20 [0.441] |
| TEMPERATURE RISE: MAX.80°C (MOTOR STANDSTILL; FOR 2 PHASE ENERGIZED) | | |
| AMBIENT TEMPERATURE -10~ 50°C [14°F ~ 122°F] | | |
| INSULATION RESISTANCE 100 MOhm (UNDER NORMAL TEMPERATURE AND HUMIDITY) | | |
| INSULATION CLASS B 130° [266°F] | | |
| DIELECTRIC STRENGTH 500VAC FOR 1 MIN. (BETWEEN THE MOTOR COILS AND THE MOTOR CASE) | | |
| AMBIENT HUMIDITY MAX. 85% (NO CONDENSATION) | | |

| REV | DESCRIPTION | DATE | DRN | Nanotec [®] PLUG & DRIVE | | | APVD | G.S. | 08.08.11 | LINEAR AKTUATOR DWG.NO LS2818S0604-T5x5-75 |
|-----|---------------|----------|------|-------------------------------------------------|----------------------------------------|----------------------------------|-----------|------|----------|---------------------------------------------------------|
| 02 | ADD RUN-OUT | 24.05.16 | B.L. | Surface specification DIN ISO 1302 | General tolerances DIN ISO 2768- cH | Work piece edge DIN ISO 13715 | CHKD | LB | 08.08.11 | |
| 01 | NEW TOLERANCE | 07.03.16 | B.L. | | | | DRN | GYQ | 08.08.11 | |
| | | | | | | | SIGNATURE | DATE | | |