

1,8° - 2 Phasen Schrittmotoren

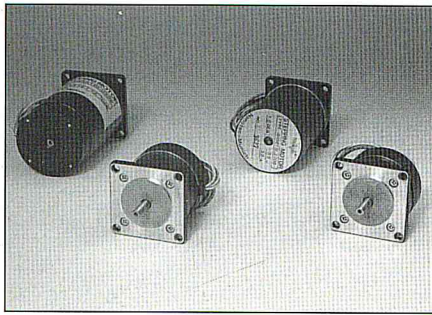

Typen 4H5618 - Größe X, S, M

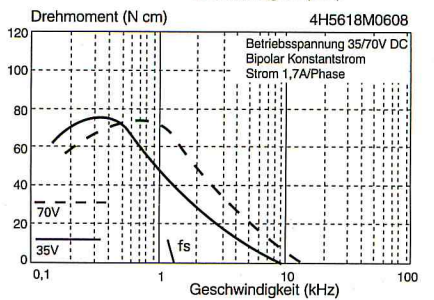
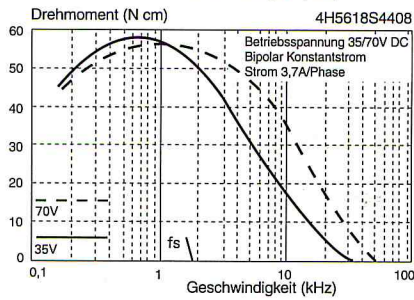
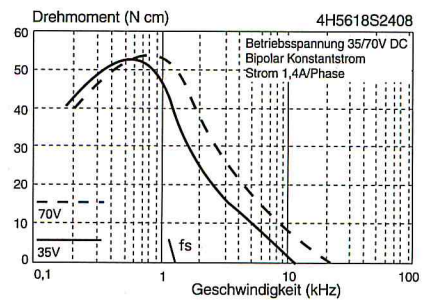
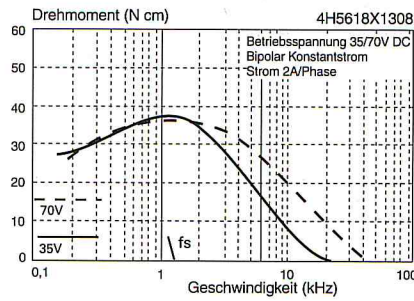

Farben der Anschlußlitzen

Unipolar

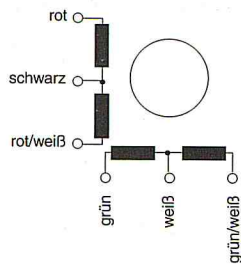

Bipolar

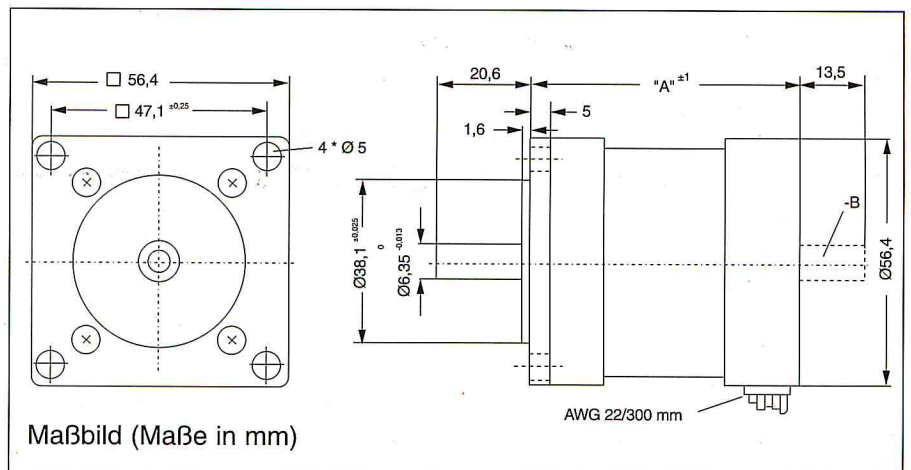
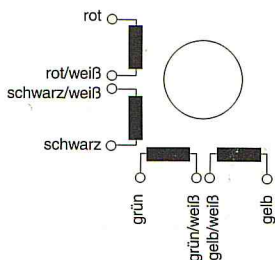

Maßbild (Maße in mm)

"A" - Motorlänge
(X,S,M) - Motorgröße

(Alle Angaben beziehen sich auf Unipolar-Betrieb)

Typ	Spannung V DC	Strom pro Wicklung A/Wicklung	Halte- moment N cm	Widerstand pro Wicklung Ohm/Wicklung	Induktivität pro Wicklung mH/Wicklung	Rotorträgh- moment g cm2	Gewicht kg	Länge "A" mm
4H5618 X1403-A	24	0,2	28,5	120	100	60	0,38	38,5
X0808-A	12	0,4	"	30	30	"	"	"
X2408-A	4	1,1	"	3,6	4,1	"	"	"
X1308-A	4	1,4	"	2,6	2,8	"	"	"
X2201-A**	1,8	3,0	"	0,6	1,1	"	"	"
X2208-A	3,0	2,5	"	1,2	1,2	"	"	"
4H5618 S2608-A	24	0,21	55	114	150	115	0,52	50,5
S0508-A	12	0,48	"	25	44	"	"	"
S2408-A	5	1	"	5	8,6	"	"	"
S3808-A	4	2	"	2	3,5	"	"	"
S4408-A	1,9	2,6	"	0,72	1,2	"	"	"
4H5618 M0308-A	24	0,3	60	80	130	130	0,57	53,5
M0108-A	12	0,6	"	20	33	"	"	"
M0608-A	6	1,2	"	5	9,2	"	"	"
M0508-A	5	2,6	"	1,42	2,6	"	"	"
M1708-A	5	3,6	"	1,4	2,4	"	"	"

-A = 1 Wellenende -B = 2 Wellenenden ** - in Bipolarausführung = 4 Anschlußdrähte