

Front view and mounting

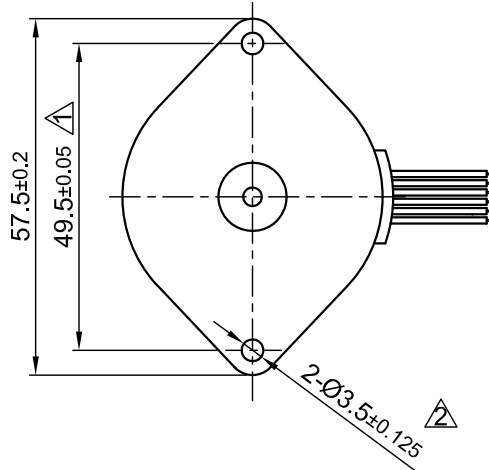

Side view

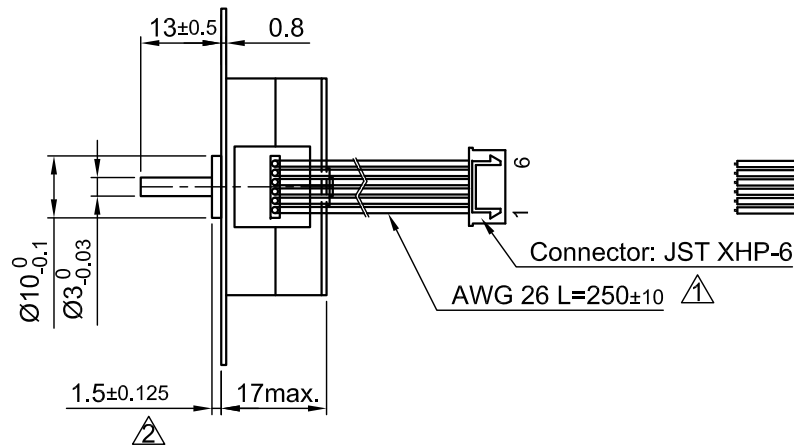

Rear view

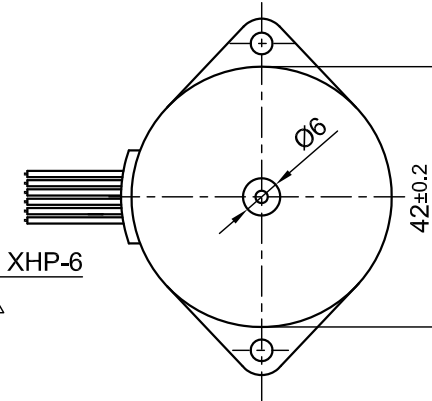

SPECIFICATION	CONNECTION	
	UNIPOLAR OR BIPOLAR-1 WINDING	BIPOLAR SERIAL
VOLTAGE (VDC)	5.0	7.0
AMPS/PHASE	0.59	0.41
RESISTANCE/PHASE (Ohms)@25°C	8.6±10%	17.2±10%
INDUCTANCE/PHASE (mH) @1KHz	4.5±20%	18±20%
HOLDING TORQUE (Nm) [lb-in]	0.05 [0.443]	0.07 [0.62]
DETENT TORQUE (Nm) [lb-in]	0.01 [0.089]	
STEP ANGLE (°)	7.5	
STEP ACCURACY (NON-ACCUM)	±7%	
ROTOR INERTIA (Kg-m ²) [lb-in ²]	9.6x10 ⁻⁷ [3.28x10 ⁻³]	
WEIGHT (Kg) [lb]	0.011 [0.243]	
TEMPERATURE RISE: MAX.80°C (MOTOR STANDSTILL; FOR 2 PHASE ENERGIZED)		
AMBIENT TEMPERATURE -10°~ 40°C [14°F ~ 104°F]		
INSULATION RESISTANCE 100 MOhm (UNDER NORMAL TEMPERATURE AND HUMIDITY)		
INSULATION CLASS B 130° [266°F]		
DIELECTRIC STRENGTH 500VAC FOR 1 MIN. (BETWEEN THE MOTOR COILS AND THE MOTOR CASE)		
AMBIENT HUMIDITY MAX. 85% (NO CONDENSATION)		

TYPE OF CONNECTION (EXTERN)			MOTOR		
UNIPOLAR	BIPOLAR		CONNECTOR PIN NO.	LEADS	WINDING
	1WINDING	SERIAL			
A ---	A ---	A ---	1	WHT	A --- COM ---
COM ---	COM ---	---	5	BLK	
A\ ---	---	A\ ---	3	RED	A\ --- B ---
B ---	B ---	B ---	2	BLU	
COM ---	COM ---	---	6	BRN	COM --- B\ ---
B\ ---	---	B\ ---	4	YEL	

for >speed ←---|
for <speed ←---|

FULL STEP 2 PHASE-Ex.,
WHEN FACING MOUNTING END (X)

STEP	A	B	A\	B\	CCW
1	+	+	-	-	↓ ↑ ↑ ↓ CW
2	-	+	+	-	
3	-	-	+	+	
4	+	-	-	+	

WIRING DIAGRAM

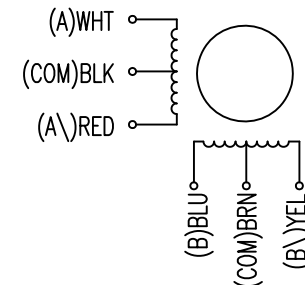

3	REMOVE LOAD SPEC.	28.02.14	J.D.
2	NEW TOLERANCES	25.07.13	A.S.
1	TOLERANCE+AMBIENT TEM.	01.03.10	J.W.
REV	DESCRIPTION	DATE	APVD



SP4275S0606-A

SCALE FREE	APVD	S.Ha.	12.03.07
X ±0.5	CHKD		
1PL ±0.2	DRN	J.W.	06.03.07
2PL ±0.1	SIGNATURE		DATE
ANGLE ±30'			

STEPPING MOTOR

DWG.NO

SP4275S0606-A