

DIMENSION (UNIT : mm)

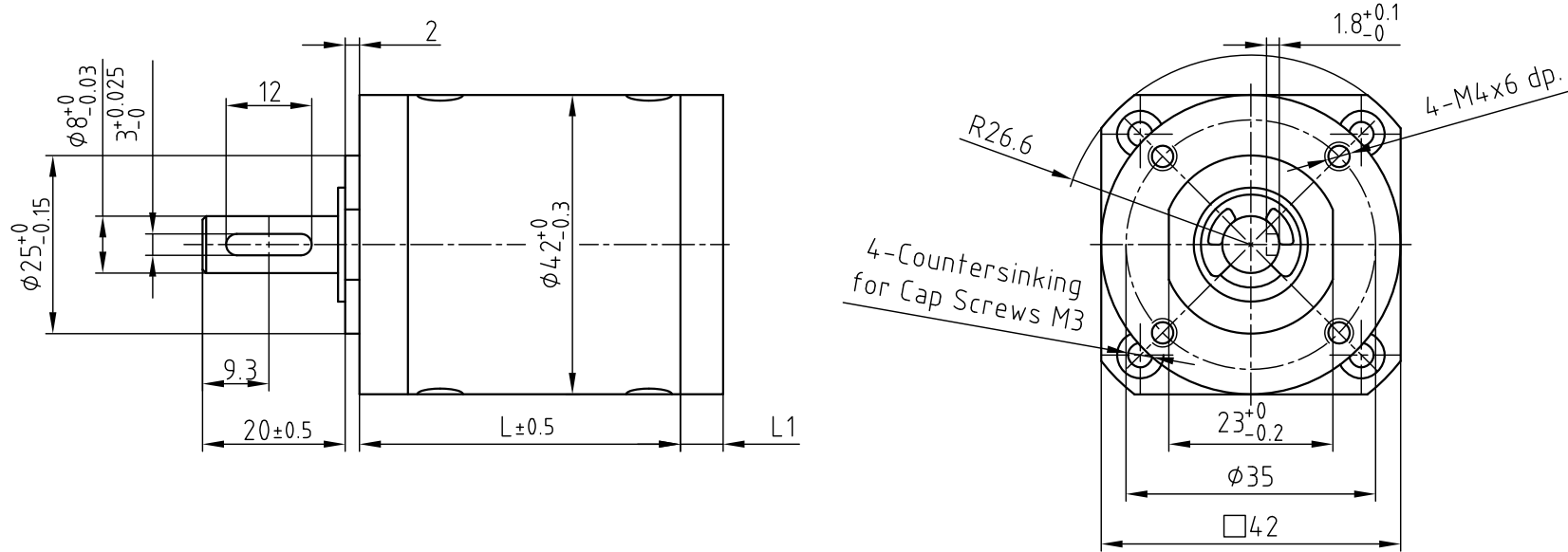

FLANGE SPECIFICATIONS

MOTOR	L1 (mm)
ST41., ST42.	6.0
DB42	

GEARBOXES SPECIFICATIONS \triangle

RATIO	RATED TORQUE (Nm) max.	MAX. TORQUE (Nm) max.	EFFICIENCY (%)	RADIAL PLAY OF \triangle SHAFT (mm)	THRUST PLAY OF \triangle SHAFT (mm)	L (mm)	WEIGHT (Kg)	SHAFT AXIAL LOAD (N)	RADIAL LOAD (10mm FROM FLANGE) (N)
1/4	0.5	1.5	80%	\triangle ≤ 0.08 \triangle	≤ 0.3	27.5	0.191	30	50 \triangle
1/14	1.0	3.0	70%			34.2	0.191		
1/24	1.0	3.0	70%			34.2	0.191		
1/49	1.8	5.4	60%			40.9	0.231		

2	UPDT DIFF. VALUES	24.01.14	J.D.	 Nanotec [®] PLUG & DRIVE	SCALE FREE	APVD	G.S.	24.01.14	GPLL40+Zwischenflansch	
1	CHANGE LENGTH	17.7.13	A.S.		X ± 0.5	CHKD			DWG.NO	GPLL40
REV	DESCRIPTION	DATE	APVD		1PL ± 0.2	DRN	J.W.	14.11.2008		
				2PL ± 0.1	SIGNATURE		DATE			
				ANGLE $\pm 30'$						