

Front view and mounting

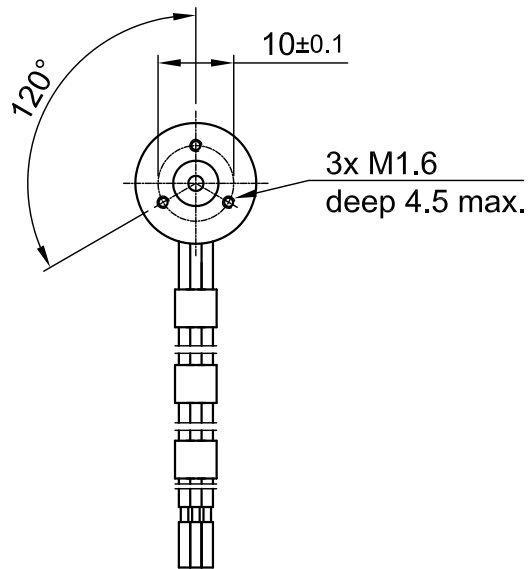

Side view

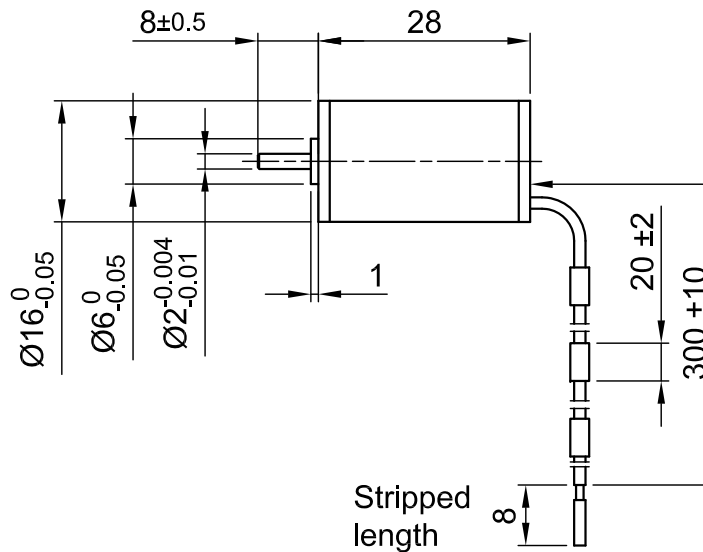

Rear view

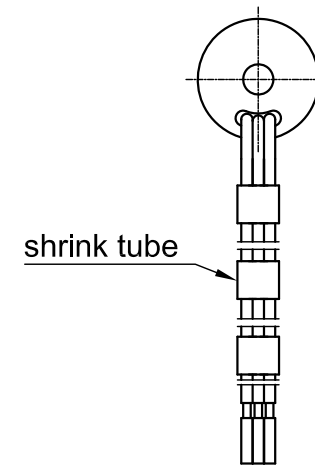

SPECIFICATION	CONNECTION	STAR
NO. OF POL./PHASE		2/3
VOLTAGE RATED (VDC)		12
CURRENT RATED/PEAK (AMP)		0.40/ 1.18
RESISTANCE/PHASE TO PHASE (Ohms) @25°C		3.05 ±10%
INDUCTANCE/PHASE TO PHASE (mH) @1KHz		0.07 ±20%
TORQUE RATED/PEAK (mNm)		1.6/ 4.8
TORQUE CONSTANT (mNm/A)		4.06
POWER RATED (W)		3.7
SPEED RATED/NO LOAD (RPM)		22000/27000 ±10%
ROTOR INERTIA (Kg-m ²)		0.4x10 ⁻⁶
WEIGHT (Kg)		0.03

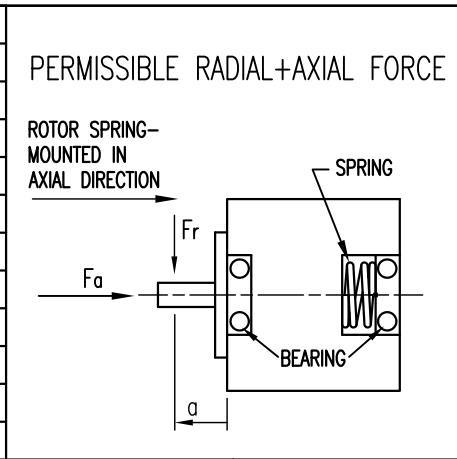

WIRING DIAGRAM			
	COLOR	FUNCTION	LEAD GAUGE
MOTOR 2 POL.	YE	U	UL1332 AWG24
	RD	V	
	BK	W	

TEMPERATURE RISE: MAX.80°C	AXIAL-FORCE Fa (N)	Fa=2 max.
AMBIENT TEMPERATURE -10°~ 50°C [14°F ~ 122°F]	DISTANCE a (mm)	5
INSULATION RESISTANCE 100 MOhm (UNDER NORMAL TEMPERATURE AND HUMIDITY)	RADIAL-FORCE Fr (N)	5 max.
INSULATION CLASS B 130° [266°F]		AXIAL RADIAL
DIELECTRIC STRENGTH 500VAC FOR 1 MIN. (BETWEEN THE MOTOR COILS AND THE MOTOR CASE)	SHAFT PLAY (mm)	0.14 0.02
AMBIENT HUMIDITY MAX. 85% (NO CONDENSATION)	AT LOAD MAX: (N)	4 4

THREE-PHASE CONNECTING STAR CONNECTION

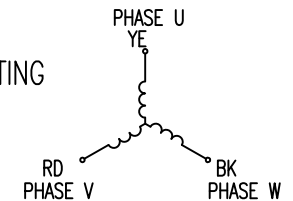

B	-	20.10.15	A.S.	 Nanotec [®] PLUG & DRIVE	APVD	G.S.	17.03.15	BRUSHLESS DC MOTOR DWG.NO DS16S012220-A
A	-	20.08.15	A.S.		Surface specification DIN ISO 1302	General tolerances DIN ISO 2768- cH	Work piece edge DIN ISO 13715	
REV	DESCRIPTION	DATE	DRN				SIGNATURE	DATE