

Front view and mounting

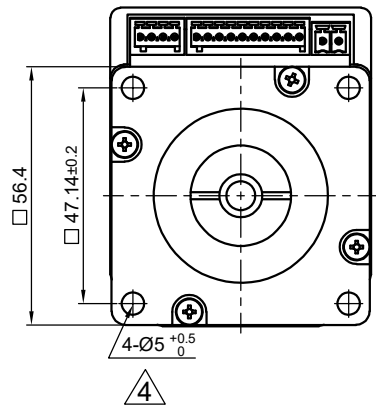

Side view

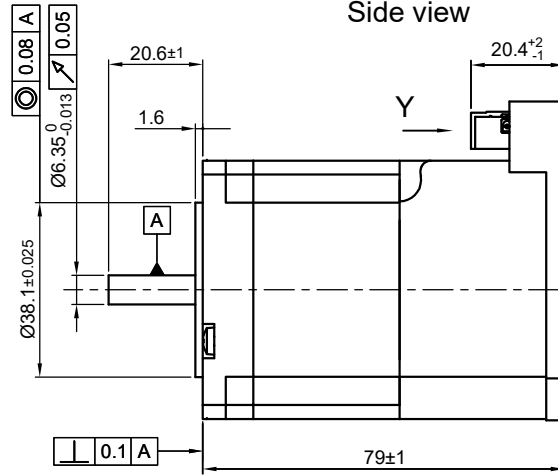

Rear view

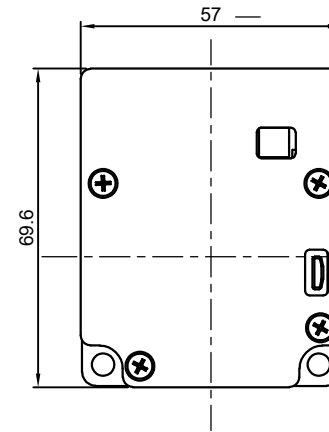

Y view

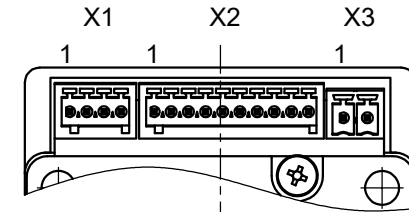

| CONNECTION | | BIPOLAR | | PERMISSIBLE RADIAL+AXIAL FORCE | | | | X1, Phoenix MCV-04 | | X2, Phoenix MCV-10 | | | | | | |
|---|------------------------------|---------------------|-----|---|------------------------------------|-------------------------------|----------------|--|----------------|--------------------|----------------|-----|---|----------------------------------|---|-----------------|
| SPECIFICATION | | | | | | | | PIN No. | Function | PIN No. | Function | | | | | |
| VOLTAGE (VDC) | | 12 TO 48 | | AXIAL-FORCE Fa (N) | Fa=10 | | 1 | GND | 1 | Input1 (+24V) | | | | | | |
| AMPS/PHASE(A) | | 4.2 | | DISTANCE a (mm) | 20 | | 2 | Analog Input(0-10V) | 2 | Input2 (+24V) | | | | | | |
| HOLDING TORQUE (Nm) [lb-in] | | 1.24 [10.98] | △3 | RADIAL-FORCE Fr (N) | 52 | | 3 | Output (open drain) | 3 | Input3 (+24V) | | | | | | |
| DETENT TORQUE (Nm) [lb-in] | | 0.04 [0.354] | | <table border="1"> <thead> <tr> <th colspan="2">X3, Phoenix FMC-02</th> </tr> <tr> <th>PIN No.</th> <th>Function</th> </tr> </thead> <tbody> <tr> <td>1</td> <td>+VCC(12-48V)</td> </tr> <tr> <td>2</td> <td>GND</td> </tr> </tbody> </table> | X3, Phoenix FMC-02 | | PIN No. | Function | 1 | +VCC(12-48V) | 2 | GND | 4 | +12V (Voltage Output, max.100mA) | 4 | -Enable +5/+24V |
| X3, Phoenix FMC-02 | | | | | | | | | | | | | | | | |
| PIN No. | Function | | | | | | | | | | | | | | | |
| 1 | +VCC(12-48V) | | | | | | | | | | | | | | | |
| 2 | GND | | | | | | | | | | | | | | | |
| STEP ANGLE (°)±ACCURACY | | 1.8±5% TO MICROSTEP | | AXIAL | RADIAL | 5 | Enable +5/+24V | 5 | Enable +5/+24V | | | | | | | |
| WEIGHT (Kg) [lb] | | 0.91 [2.01] | | SHAFT PLAY (mm) | 0.2Max | 0.02 | 6 | -Direction +5/+24V | 6 | -Direction +5/+24V | | | | | | |
| OVERTEMPERATURE PROTECTION (ELECTRONICS): 75°C | | | | AT LOAD MAX: (N) | 200 | 4.5 | 7 | Direction +5/+24V | 7 | Direction +5/+24V | | | | | | |
| AMBIENT TEMPERATURE -10°~ 50°C [14°F ~ 122°F] (HIGHER TEMPERATURE REDUCES DUTY CYCLE) | | | | APVD | | G.M. | 01.08.13 | 8 | -Clock +5/+24V | 8 | -Clock +5/+24V | | | | | |
| INSULATION RESISTANCE 100 MOhm (UNDER NORMAL TEMPERATURE AND HUMIDITY) | | | | CHKD | | | | 9 | Clock +5/+24V | 9 | Clock +5/+24V | | | | | |
| INSULATION CLASS B 130° [266°F] | | | | DRN | | GYQ | 01.08.13 | 10 | GND | 10 | GND | | | | | |
| DIELECTRIC STRENGTH 500VAC FOR 1 MIN. (BETWEEN THE MOTOR COILS AND THE MOTOR CASE) | | | | SIGNATURE | | | | PLUG&DRIVE MOTOR DWG.NO PD4-C5918M4204-E-01 | | | | | | | | |
| AMBIENT HUMIDITY MAX. 85% (NO CONDENSATION) | | | | DATE | | | | | | | | | | | | |
| 4 | HOLE Ø5 ADD TOLERANCE +0.5/0 | 11.07.22 | YBY | PLUG & DRIVE | | | | | | | | | | | | |
| 03 | NEW HOLDING TORQUE | 11.10.16 | GYQ | | | | | | | | | | | | | |
| REV | DESCRIPTION | DATE | DRN | Surface specification DIN ISO 1302 | General tolerances DIN ISO 2768-cH | Work piece edge DIN ISO 13715 | | | | | | | | | | |