

Front view and mounting

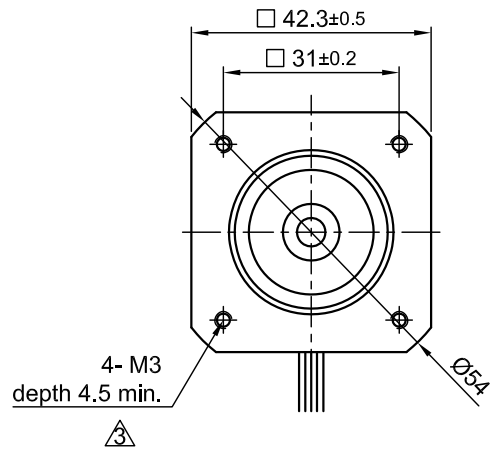

Side view

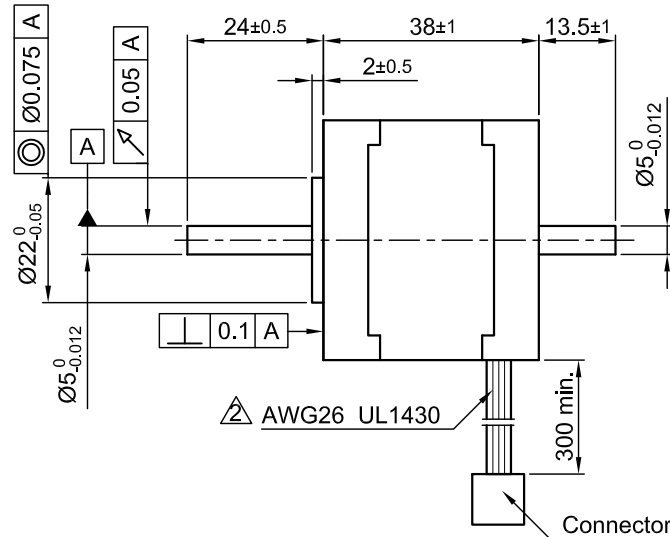

Rear view

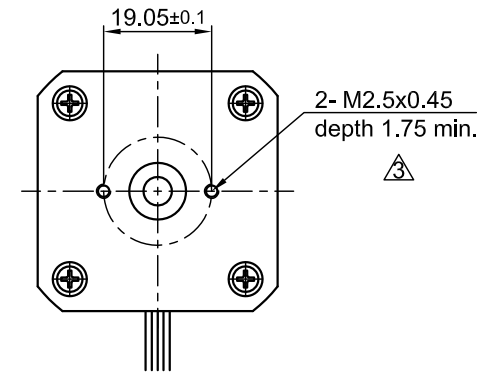

Connector: JST XHP-6

SPECIFICATION	CONNECTION	
	UNIPOLAR OR BIPOLAR-1 WINDING	BIPOLAR SERIAL
VOLTAGE (VDC)	12	17.0
AMPS/PHASE	0.4	0.28
RESISTANCE/PHASE (Ohms)@25°C	30±15%	60±15%
INDUCTANCE/PHASE (mH) @1KHz	25±20% \triangle	100±20% \triangle
HOLDING TORQUE (Nm) [lb-in]	0.28 [2.478]	0.396 [3.505]
DETENT TORQUE (Nm) [lb-in]	0.98x10 ⁻² [8.673x10 ⁻²]	
STEP ANGLE (°)	1.8	
STEP ACCURACY (NON-ACCUM)	±5%	
ROTOR INERTIA (Kg-m ²) [lb-in ²]	5.7x10 ⁻⁶ [1.95x10 ⁻²]	
WEIGHT (Kg) [lb]	0.24 [0.53]	

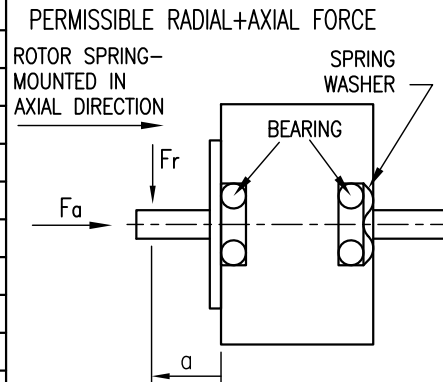

AXIAL-FORCE Fa (N)	Fa=7			
DISTANCE a (mm)	5	10	15	20
RADIAL-FORCE Fr (N)	AXIAL		RADIAL	
	58	36	26	20
SHAFT PLAY (mm)	0.08		0.02	
AT LOAD MAX: (N)	4.5		4.5	

TYPE OF CONNECTION (EXTERN)	MOTOR					
	UNIPOLAR	BIPOLAR		CONNECTOR PIN NO.	LEADS	WINDING
A ---	A ---	A ---	1	BRN	A	
COM ---	COM ---	COM ---	5	BLK	COM	
A\ ---	A\ ---	A\ ---	3	ORG	A\	
B ---	B ---	B ---	2	RED	B	
COM ---	COM ---	COM ---	6	WHT	COM	
B\ ---	B\ ---	B\ ---	4	YEL	B\	

for >speed \leftarrow
for <speed \leftarrow

FULL STEP 2 PHASE-Ex., WHEN FACING MOUNTING END (X)

STEP	A	B	A\	B\	CCW	CW
1	+	+	-	-	↓	↑
2	-	+	+	-	↓	↑
3	-	-	+	+	↓	↑
4	+	-	-	+	↓	↑

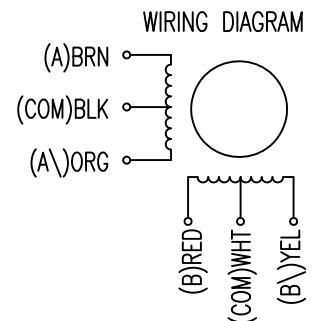

3	rework draw/change depth M2.5/M3	09.02.16	A.S.
2	UL NO.	03.03.09	J.W.
1	INDUCTANCE	26.04.07	J.W.
REV	DESCRIPTION	DATE	DRN

Nanotec
PLUG & DRIVE

Surface specification	General tolerances	Work piece edge
DIN ISO 1302	DIN ISO 2768- cH	DIN ISO 13715

APVD	S.Ha.	26.02.07
CHKD		
DRN	J.W.	29.11.06
SIGNATURE	DATE	

STEPPING MOTOR

DWG.NO

ST4118M0406-B