

View X

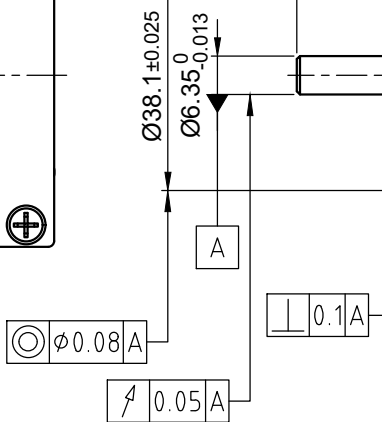

Label details

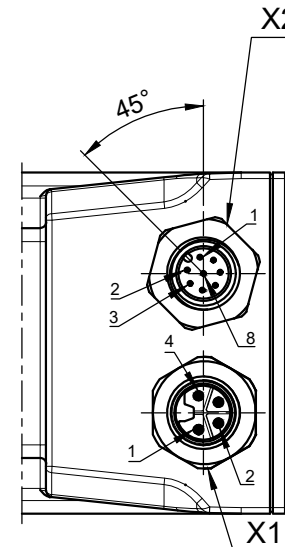

X1 MOTOR	
M12 / 4-Pole / L-Coding / male	
Pin No.	Function
1	A\
2	A
3	B
4	B\
cable shield on housing	

X2 ENCODER	
M12 / 8-Pole / A-Coding / male	
Pin No.	Function
1	Clock+
2	Clock-
3	Data OUT+
4	Data OUT-
5	GND
6	n.c.
7	n.c.
8	+UB
cable shield on housing	

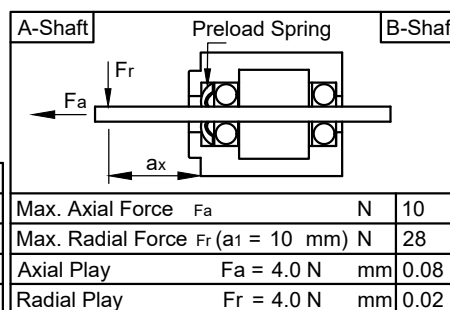

ENCODER SPECIFICATION			
Operating Voltage	V DC	4.75...15	
Singleturn Enc. Resolution	bit	17	
Multiturn Enc. Resolution	bit	16	
Interface	SSI		

MOTOR SPECIFICATION		
Nominal Operating Voltage	V DC	48
Max. Operating Voltage	V DC	60
Current per Winding	A	4.2
Resistance per Phase (25°C)	±15% Ω	0.5
Inductance per Phase (1 kHz)	±20% mH	1.6
Holding Torque	Nm	1.4
Step Angle	±5% °	1.8
Rotor Inertia	kg m <sup>2</sup>	30 x10 <sup>-6</sup>

GENERAL MOTOR SPECIFICATION		
Ambient Temperature	°C	-10 ... 50
Max. Ambient Humidity (non condensing)	%	85
Protection Class (except shaft outlet)		IP65
Protection Class (shaft outlet)		IP54

ISO 8015	ISO 1302	ISO 2768 cK	ISO 13715	Weight ±10%	kg
			Date	Name	
			Drawn	14.11.2023	Schneid_A
			Reviewed	15.11.2023	Sejdini_B
			Released	15.11.2023	Sejdini_B
01	revise drawing	Kolev_I	16.02.2024		
REV	Rev. Text	Name	Date		

		20002167		A4 Page 1
		State: Released		
Rev: 01		CONFIDENTIAL		
<p style="text-align: center;">ASA5618M42-W1</p>				