

# GP56-N

## Low-noise planetary gearbox

The low-noise planetary gearboxes of the GP56-N series are designed for brushless DC motors and stepper motors with NEMA 23/24 flange as well as for DFA68 external rotor motors. They offer noise reduction by up to 10 dB compared with traditional metal gearboxes. The gearboxes are available in nine different versions. Thanks to their modular concept, they are quick and easy to adapt to individual customer requirements.

### Low-noise operation

The planetary gears and the ring gear of the first stage consist of a high-quality, low-wear plastic that prevents noise development. The helical toothing allows the teeth to mesh gradually which results in a smoother transmission of forces so that vibrations and noise are further reduced.

### Long service life

The gearboxes are available in a single-stage and dual-stage design and come standard with a keyway. The service life is 5,000 hours at 3,500 rpm.

- Rated torque 1.5–11.8 Nm
- 9 reductions from 3 to 35
- Max. backlash 18–43 arcmin

### For many applications

Thanks to their compact design, the GP56 gearboxes are ideally suited for applications in medical devices and building automation. For use in harsh environments, they are protected against penetration by dust and liquids according to IP54. For vertically installed motors, the gearboxes can also be equipped with radial shaft sealing rings.

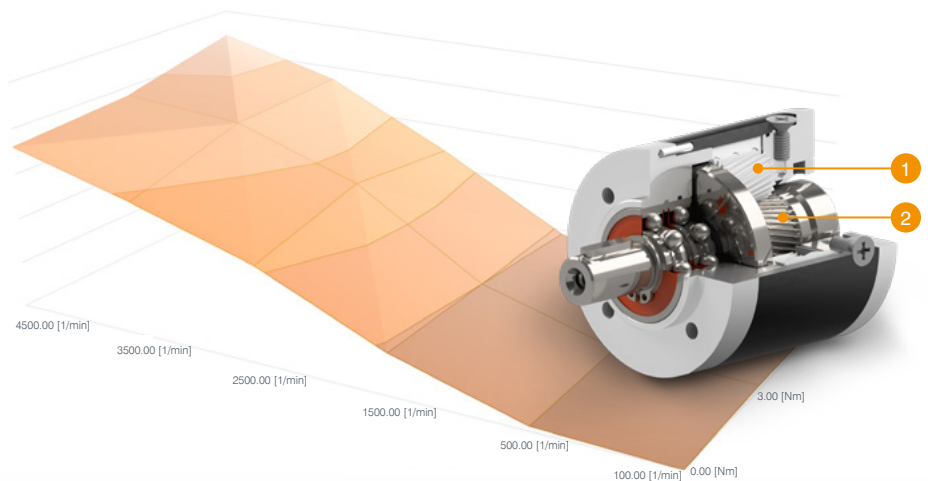

1 Planetary and ring gears made of high-quality low-wear plastic

2 Helical teeth

GP56-N2



GP56-N1

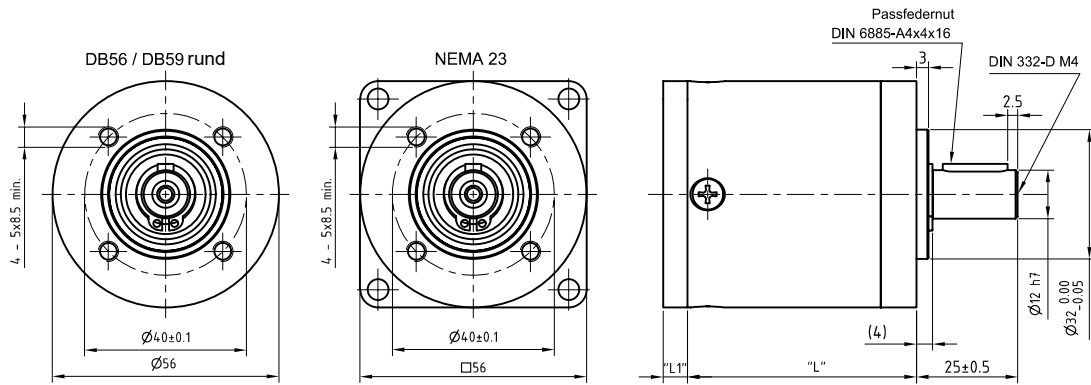

	GP56-N1	GP56-N2
<b>Reductions</b>	3/4/5/6	11/16/20/26/35
<b>Rated torque</b>	1.7-2 Nm	6.4-11.8 Nm
<b>Rated speed</b>	3,500 rpm	3,500 rpm
<b>Service life</b>	5,000 h	5,000 h
<b>Efficiency</b>	93%	86%
<b>Matching motors</b>	NEMA 23/24, DFA68	NEMA 23/24, DFA68